



CLD Board Members & Capital Campaign Committee

Nick Anthony
Executive VP & CIO
Duke Realty

Troy Arthur
Director Of Academic and Membership Affairs
NCAA

Christopher Barney
President
Team Cruiser Conversion Company

Dennis E. Bland, Esq., **
President
Center for Leadership Development

Dr. Robert L. Bowen, P.E.*
Founder & Chairman
Bowen Engineering Corporation

Mark Bradford*
Regional CEO
Old National Bank

Doug Brown
CEO
Fusion Alliance

Quinn Buckner
VP of Communications
Indiana Pacers

Patrick F. Carr
President and Chief Executive Officer
UnitedHealthOne

Matthew Conrad*
Attorney
Frost Brown Todd

Eric Dozier
VP - North American Oncology
Eli Lilly and Company

Dr. Sue Ellspermann
President
Ivy Tech Community College

Daniel Elsener
President
Marian University

Caryn Glawe*
Partner
Faegre Drinker Biddle & Reath LLP

Jeffrey Harrison*
President & CEO
Citizens Energy Group

Tom Hiron**
Founder & Board Chair
Hiron

Steven Jones, CLD '81**
Dean for Professional Development
Wabash College

Thomas A. King**
Retired President & CEO
Indiana State Museum & Historic Sites

Jim Morris**
Vice Chairman
Pacers Sports & Entertainment

David O'Neal
Director of Business Development
The Westport Group

John Otteson*
Market Executive, Middle Market Banking
JPMorgan Chase & Co.

George Pillow, Jr.
President & CEO
Pillow Logistics

Derica W. Rice
Retired
Eli Lilly and Company/CVS Health
CVS Caremark

Karin Sarratt
Executive Vice President
The Companies of OneAmerica

Jim Sadtler
Retired
AES Indiana

Jerry D. Semler*
Chairman Emeritus
The Companies of OneAmerica

Joe Slaughter
Retired
Herff Jones

LaTanya Smith
Licensed Sales Agent
UnitedHealthcare

Daniel H. Spitzberg

Stephen A. Stittle*
Indiana Managing Partner
SmithAmundsen LLC

Patrick Walsh
President and Chief Operating Officer
Emmis Communications Corporation

Leo "Skip" Watson
Executive VP & Regional Sales Executive
KeyBank

*Denotes Board Member & Capital Campaign Committee member **Denotes Capital Campaign Committee member

We honor Sydney "Syd" Steele's significant legacy and will make sure his contributions to our mission, youth and community are forever retained in our memory. Thank you, Syd. Peace and love.



2425 Dr. Martin Luther King Jr. St., Indianapolis, IN 46208 | CLDinc.org | 317.923.8111



Cultivating Character, Empowering Youth, Enriching Community



African American Youth Need Our Help to Rise

At the Center for Leadership Development (CLD), our vision is to empower Central Indiana African American students to achieve the highest personal, postsecondary, and professional success through comprehensive character, academic, and career development. Additionally, we aspire to help Indianapolis lead the nation in Black youth academic achievement.

CLD’s overarching aspiration is to amplify the value of education and expand the circle of Indianapolis African American youth who flourish in the classroom and their higher learning pursuits.

CLD’s many enriching programs combat the massive educational and achievement gaps that hinder far too many African American students. As a result, CLD Alumni graduate high school and pursue postsecondary education at higher rates than their peers in central Indiana and statewide. Unfortunately, however, thousands of youth in our community are performing far beneath their great potential. According to the Indiana Department of Education (IDOE):

- 1 Only 51% of African American males graduate high school in four years;
- 2 78% of African American 4th-grade students lack proficiency in reading;
- 3 83% of 4th grade African American males scored below grade level in reading;
- 4 25% of African American students in Indiana received graduation waivers
- 5 23% of African American college students require remediation.

If education is the gateway to personal success, career opportunities, higher incomes, better health, and improved quality of life, then, without intervention, our Black youth and families face bleak prospects. Therefore, for the sake of our youth and our community, we must confront these disparities.

CLD helps students RISE. Collaborating with our K-12, higher education, and corporate/community partners, we will help Indianapolis outspread academic engagement and commitment with Black students throughout Marion County. Additionally, we seek to help grow the number of students achieving honor roll status. CLD has worked for over four decades to equip African American students and parents with the support and educational resources they need to overcome obstacles, flourish and enrich their communities. CLD programs have proven highly effective, and our ability to reach and impact many more students is limited only by our lack of capacity and resources.

CLD’s \$33 million Rise Campaign is a bold step to expand our reach to serve lower-income neighborhoods and more Black youth than ever before. With your support, we can help many more students RISE and actualize their immense potential. Together we will achieve our powerful shared vision of many more bright African American students in Central Indiana thriving and succeeding.

TOGETHER, WE RISE.

MISSION

The mission of the Center for Leadership Development is to foster the advancement of minority youth in Central Indiana as future professional, business and community leaders by providing experiences that encourage personal development and educational attainment.

\$33M RISE CAMPAIGN

Capacity Building & Program Expansion:
\$4.5M

Building Expansion, Maintenance & Infrastructure:
\$8.5M

Annual Operating, 5 Years:
\$13.5M

Marketing & Campaign Awareness:
\$500K

Endowment for Sustainability:
\$6M

\$4.5M Capacity Building & Program Expansion

CLD seeks to widen the circle and get more students and families engaged in the value proposition of education and scholarship by proactively connecting them to CLD programming both at our primary campus and through **satellite** and **in-school** locations in our highest-crime, lowest-income neighborhoods. By leveraging these new locations and our expanded capacity, we plan to increase program participation to 6,500 and render services to 15,000 annually.

Target zip codes for CLD satellite locations and in-school programming: 46222, 46208, 46226, 46218, 46235, 46201, 46219 and 46205.



\$8.5M BUILDING EXPANSION, MAINTENANCE & INFRASTRUCTURE



Demonstrating CLD's broader commitment to assume a greater leadership role in helping uncover the depths of youth potential, the College Prep Institute learning lab will be expanded to include private space for tutoring and guidance counseling (above and below) which will equip more students for postsecondary admissions, persistence and graduation. The lab will also feature new technology and study spaces to enhance student learning objectives.

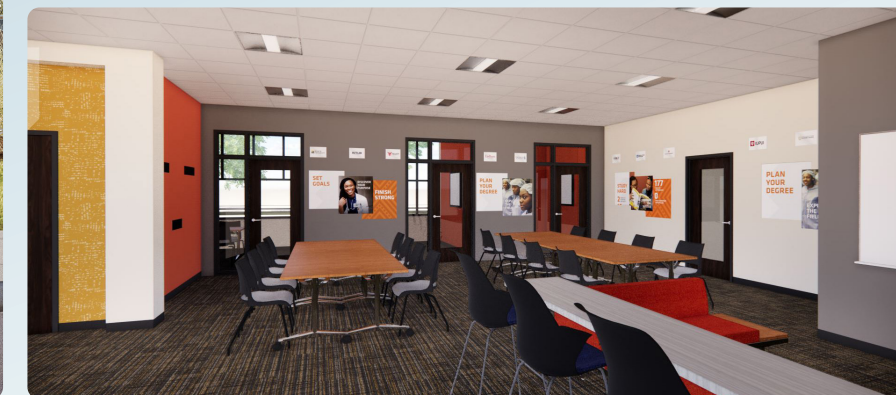

Motivated by mounting academic and social challenges and inspired by a belief that CLD has real answers to overcome these challenges, CLD aspires to establish an exemplary youth development center of unparalleled distinction. Indeed, CLD envisions making Indianapolis home to one of the most transformative, state of the art, models in the nation dedicated to effecting the highest academic, college and career achievement in African American youth. To increase our overall

capacity that will allow CLD to serve thousands more students annually, and engage more youth to widen the circle of academic achievement, CLD is doubling the size of its headquarters from 20k sq. ft. to 40k sq. ft. Students engaged at various satellite locations and within our in-school programs will be invited to our expanded building where they will receive personalized education enrichment services such as free guidance counseling, tutoring and reading support.



The building will feature CLD's first auditorium-style space where we are able to accommodate approximately 375 people at one time. Five classrooms will open up to one larger space. These additional rooms, and the opportunity to host large groups, increases CLD capacity to hold more programs concurrently, serve more youth and families, and lessens the need for offsite space rental.

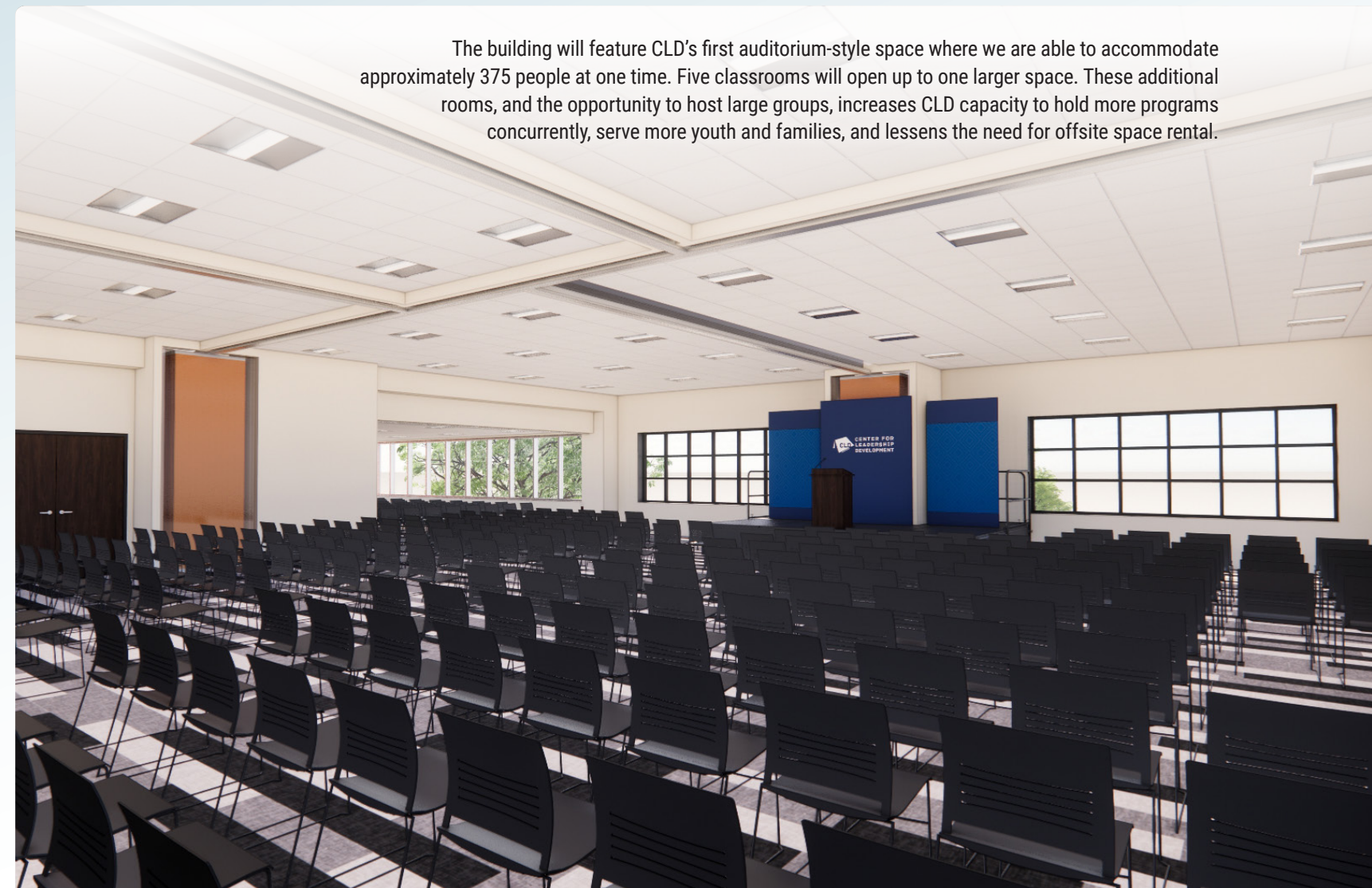

\$33M RISE Campaign

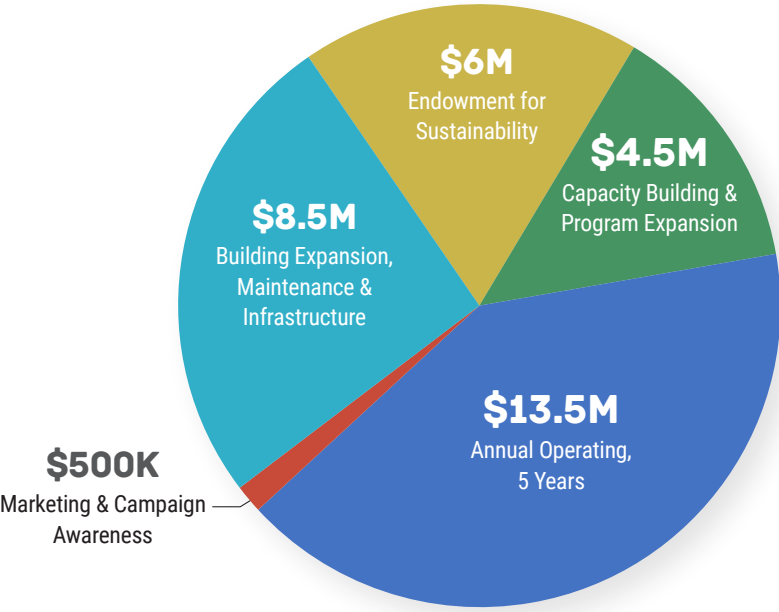

\$4.5M Capacity Building & Program Expansion

- Establish satellite locations in high crime, low income areas across central Indiana
- Increase annual program participation to 6,500, and services provided to 15,000, annually
- Hire new staff, provide professional development opportunities and offer competitive salaries and benefits
- Scale CLD programs and services to meet the need of communities near and far

\$13.5M Annual Operating, 5 Years

- Follow students starting in 4th grade through college to ensure better preparation and postsecondary completion
- Establish on-campus groups, services and mentoring support for CLD students attending college
- Support increased operating expenses

\$500K Marketing & Campaign Awareness

- Implement a robust communications plan to raise awareness of CLD and its impact
- Enroll more students and parents in programs and services
- Increase corporate and community involvement
- Conduct outreach to engage students in high crime, low income areas

\$8.5M Building Expansion, Maintenance & Infrastructure

- Expand CLD headquarters by 20,000 sq. ft. to accommodate increased programs and services provided
- Expand College Prep Institute with updated technology and additional space to enhance youth learning objectives

\$6M Endowment for Sustainability

- Develop a fund to sustain CLD mission during future, unforeseen or disruptive societal events that can disrupt and dismantle non-profit organizations and their important mission work

If the young are not initiated into the village, they will burn it down just to feel its warmth.

– African proverb

CLD PRINCIPLES FOR SUCCESS

Character Development

CLD empowers youth by instilling valuable lessons that promote respect for self and others, self-worth, integrity, discipline, purpose and other character traits vital to success.

Educational Excellence

CLD inspires, develops and challenges its youth participants to pursue the highest levels of academic and educational achievement.

Leadership Effectiveness

CLD provides youth with the training and practical experiences required to positively lead and serve their peers in schools, churches, organizations, businesses and corporations, neighborhoods and communities.

Community Service

CLD believes that one critical component in becoming a truly effective leader is learning to serve and help the people you lead. CLD demonstrates this commitment to community service and philanthropy by teaching African American and minority youth, the purpose, method and process for rendering service to those in need.

Career Achievement

CLD exposes its youth to the myriad of career opportunities available to them. In addition, CLD facilitates this career achievement by educating young people in the knowledge, skills and educational requirements necessary to realize their career aspirations.

What role can you play to help transform our community and the lives of deserving youth?

Consider leaving a legacy gift to CLD through an estate gift or by designating CLD as an insurance beneficiary or by other means. You can make a meaningful impact on the future of young people through a gift that costs nothing in your lifetime.

For more information, contact:

DENNIS E. BLAND, CLD '82

President, CLD

dbland@cldinc.org 317-923-8111

MELANIE FRAZIER, CFRE

Campaign Manager, CLD

mfrazier@cldinc.org 317-923-8111